

Layering Leaves Daisy Flip Flop

Supplies:

- Stamp Sets – Layering Leaves, Light the Candles
- Card Stock – Thick Very Vanilla; Pretty Peacock, Fresh As A Daisy DSP
- Stamp Pads – Pretty Peacock
- Misc. – Stylish Shapes Dies

Measurements:

- Thick Very Vanilla cardstock: 7-3/4" x 5-1/2" (19.5cm x 14.8cm)
- Designer Paper: 5/8" x 5-1/4" (1.5cm x 14.3cm); 1-3/4" x 5-1/4" (4.5cm x 14.3cm)
- Scrap of Pretty Peacock for circle die

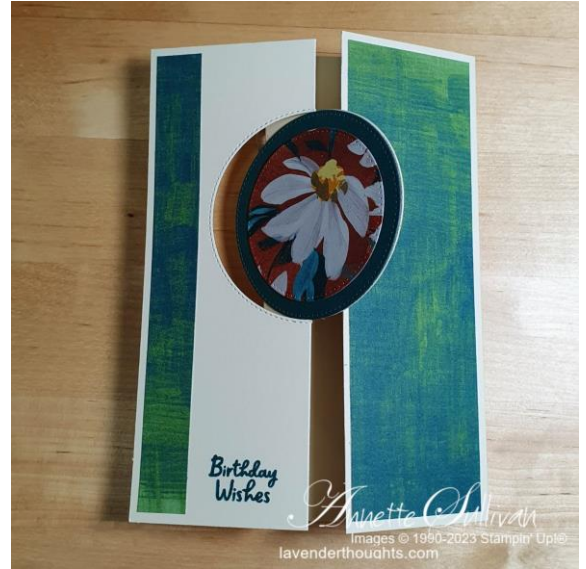

Instructions:

1. Use the circle die that is approximately 2-5/8" in diameter. Take a Sharpie or permanent marker and place marks to show the centre (diameter) as shown in the photo.
2. Die cut a circle with Pretty Peacock cardstock.
3. Take the card base and draw a light line that is 2-1/4" (5.5cm) from the left hand edge of the card. Draw another light line that is 3" (7.5cm) from the left hand edge of the card.
4. Place the card base with circle die on cutting plate of die cutting machine. Line up the centre of the circle die along the 2-1/4" (5.5cm) line about 3/4" (2cm) down from the top of the card.
5. Align the top cutting plate so that the edge of the plate lines up with the centre of the circle die (along the pencil mark). Run through the die cutting machine. This will only cut the left hand part of the circle.

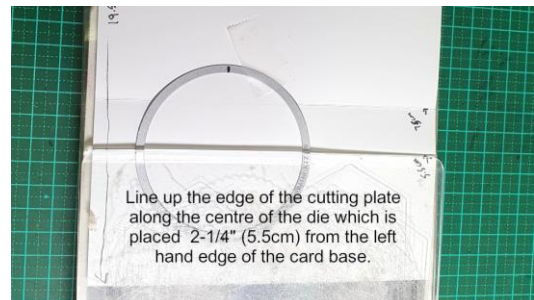

6. Turn the card base around, keeping the circle die in place. Align the top cutting plate so that the edge lines up with the 3" (7.5cm) line. Run through the die cutting machine. This will only cut the right hand part of the circle.

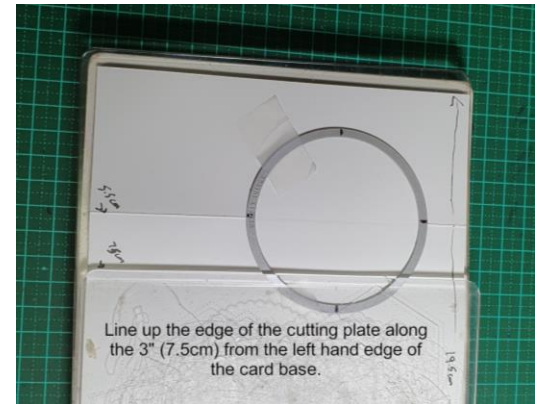

7. Erase the lines and score above and below the cut circle at 2-1/4" (5.5cm) and 3" (7.5cm). Do not score through the circle area.
8. Attach the thin strip of DSP to the left hand edge of the card.
9. Stamp a sentiment on the circle using Pretty Peacock ink.
10. Stamp a sentiment on the lower part of the left panel using Pretty Peacock ink.
11. OPTIONAL: Add a thin strip of DSP to the right hand edge of the card.



12. Turn the card base over and score 2" (5cm) from the left hand edge. Attach DSP to that panel.
13. Attach the Pretty Peacock circle over the circle on the card base.
14. Die cut a piece of DSP one size smaller than the die used on the card base and attach to the Pretty Peacock circle.
15. Message can be written on the panel beside the large DSP or on the other side.

